



HEALTH AND SAFETY GUIDE

FOR YOUR ADULT CLASS

Last Updated: June 11, 2020

Starting at the end of June, The Crucible will slowly begin to offer adult classes in a limited capacity, with new health and safety policies in place, in accordance with the most up-to-date orders defined by the county department of health, under the guidance of the state.

We are an industrial arts school dedicated to safety—and we are working hard to implement best practices put forth by the Alameda County Public Health Department, the City of Oakland, the State of California, the Center for Disease Control, the federal government, and the World Health Organization.

As The Crucible welcomes students back to the studios, we strive to create a welcoming environment to encourage creativity in a safe and responsible way. **Please carefully review the following to know what to expect and how to prepare for your next Crucible class.**

If you have any questions or concerns, please reach out to us so we can discuss them with you.

Email: registrar@thecrucible.org

Phone: (510) 444-0919

Your participation in class is dependent on following the health and safety rules in this document. We are looking forward to safely welcoming you back to The Crucible to get hands-on in the industrial arts.

IMPORTANT CHANGES TO NOTE

- ⇒ **Class sizes have been reduced to allow for 6 feet of space between students and faculty.** Classes are led by no more than two Crucible faculty members. Your safety—and the safety of our faculty—are everything to us.
- ⇒ **Everyone coming onto The Crucible property must wear a 100% cotton cloth mask.** All students must wear a mask for the duration of their class, unless otherwise instructed by their faculty member or when drinking water or eating in designated areas. The CDC has a [guide to acceptable cloth masks](#) that help prevent the spread of infection. Bandannas are not accepted inside The Crucible.
- ⇒ **All students must sign our General Liability Waiver with an additional agreement and waiver** that outlines The Crucible and your expectations and agreements at this time.
- ⇒ **You will be asked some health questions and to complete a temperature check upon arrival.**
- ⇒ **Be prepared to practice social distancing.** While in The Crucible building, you will be asked to not mingle with students and staffers from outside of your class pod. Check-in, building pathways, eating areas, and bathroom usage are designed to minimize close contact.
- ⇒ **Please limit the number of personal items you bring to class.** And take care not to leave valuables or belongings anywhere in your vehicle.

BEING PREPARED FOR CLASS

LIMIT EXPOSURE

It is important to us that our students, staff, and faculty can safely learn and work at The Crucible. **Before coming to class, students should be considerate about limiting their risk and exposure.** Strictly follow all Alameda County Public Health Department guidelines and policies around social distancing and safety requirements.

Do not come to class if you are exhibiting any signs of illness or flu or have a fever or if anyone that you've had close proximity to has been ill with a respiratory illness for the past two weeks, exhibited any symptoms of what could be a variant of COVID-19, or has a fever, cough, or other active illness which might be contagious that you are aware of.

Do not come to class if anyone in your household has been exposed to COVID-19 in the past two weeks, or gone out without appropriate hand-washing, social distancing, and protective personal equipment unless they are a front line worker or practicing activities the ACPHD has approved for not wearing a mask (such as running).

See more on *Contact Tracing* on page 7.

BEING PREPARED FOR CLASS

CHECK-IN

All students arriving for class must check-in first at the student entrance of The Crucible. We will all practice social distancing and wear masks during the check-in. A staff member will confirm your registration, do a temperature check, then ask you how you are feeling and if there is any information we must be made aware of prior to you coming on site, such as temperature change, any illness or symptoms of illness, etc.

Please arrive on time—especially now! Check-in will open 30 minutes before the start of class. We ask that you arrive at least 15 minutes before your class begins.

Respect social distancing guidelines and maintain a six-foot distance between you and your fellow students waiting to check-in.

What To Wear:

- ☑ **Students MUST wear all natural fiber clothing** such as denim, cotton, linen or leather. Synthetics like nylon, polyester, and spandex, are not permitted around open flame.
- ☑ **You MUST arrive and wear a 100% cotton cloth mask the entire time you are on Crucible property.**
- ☑ **NO flip-flops, sandals, or open-toed shoes** of any kind are allowed in the studio. If you arrive in open-toed shoes, you will be asked to go home and change into closed-toe, closed-heel (i.e. fully enclosed) shoes.
- ☑ **Please dress in long pants;** NO SHORTS are allowed in the studio. Skirts are not recommended.
- ☑ **Bring your own large water bottle!** Single use water bottles will be available, but you can help reduce our plastic waste by bringing your own.

DURING CLASS

KNOW WHERE TO GO

After checking in, students will be directed to go immediately to their classrooms or the restroom, if needed. Students should not be wandering around the space before class and all tours of the studio before class are suspended until further notice.

Clearly marked pathways will help guide students through the building in a one-directional manner, to reduce students crossing pathways. Classes will enter and exit the building following posted signage and remain clear from unnecessary areas. For mezzanine access, the south stairway will be for going up and the north stairway will be for going down. Classrooms, pathways, and other necessary-use areas will be marked with space guidelines to implement physical distancing.

We ask all staff, faculty, and students to support these traffic patterns to minimize contact with those outside your class.

LUNCH BREAKS

Classes will take an official lunch break during class at a preplanned interval to ensure adequate social distancing between other class groups. The Crucible will have tables set up in the fenced in backyard area, as well as in the large, open Events Space inside The Crucible for students to eat lunch.

There will be indications on the table to help ensure appropriate distance between seats. Please sit with at least 6 feet of space between individuals. Sanitizing wipes will be provided around the eating areas and students are encouraged to wipe down their space before and after using. All eating areas will be monitored by staff, and sanitized between use.

For students who wish to buy lunch, Mandela Grocery Cooperative is a small grocery store on 7th Street that is currently open Monday-Saturday and has a great food selection. The Crucible's kitchenette, including the microwave and fridge are off limits to students at this time.



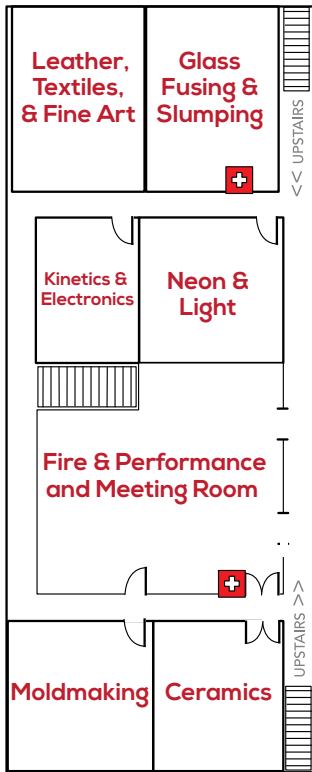

FIND YOUR CLASS

MEZZANINE UPSTAIRS

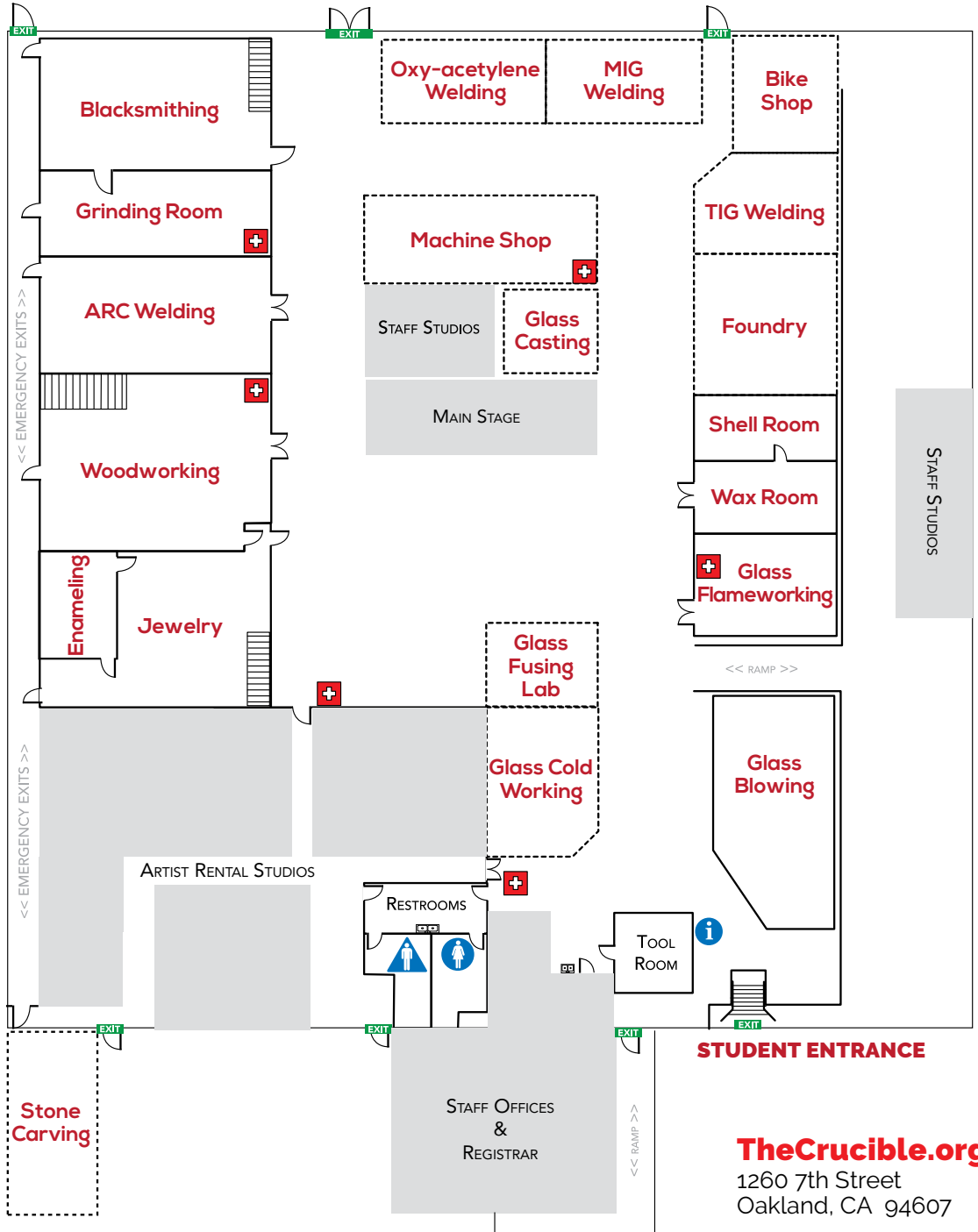

DOWNSTAIRS / MAIN-LEVEL



-  No Access
-  FIRST AID KITS
-  EMERGENCY EXITS
-  INFORMATION & REGISTRATION



TheCrucible.org
 1260 7th Street
 Oakland, CA 94607

PUBLIC SAFETY

STAYING HEALTHY

Please immediately report any unusual illness or symptoms to The Crucible. Do not return to The Crucible if you or anyone in your household is exhibiting any signs of illness or flu. If someone at The Crucible has a confirmed case of COVID-19 and was on-site in the last fourteen days at the same time when you were in the building, The Crucible will reach out as soon as we are notified and alert you by email about the potential exposure.

CONTACT TRACING

Contact tracing is one of the keys to managing risk and identifying potential exposures. We are working under the guidance of the Alameda County Public Health Department to keep your experience at The Crucible rewarding and safe. Contact tracing is a critical part of keeping our community safe.

While taking a class at The Crucible, **PLEASE do not interact with other students or Crucible staff that are not part of your class.** Managing a social bubble both inside and outside of The Crucible is a critical aspect of both safety and contract tracing.

We are in direct communication with the Alameda County Public Health Department and in the event of a confirmed illness will be in direct collaboration with them to determine potential transmission within our building and notify any students who may have been potentially exposed. Confidential information will not be shared with anyone other than the Health Department should a case of COVID-19 be confirmed.